



INSTALLATION GUIDE



ALUMINIUM CLADDING



STORAGE & HANDLING

- Always handle Alumate Products with care. Do not dump or drop when loading or unloading.
- Profiles should be carried on their edge for better support. Take care of cut board ends as they may be sharp.
- Store Alumate Products away from the elements on a dry, flat surface supported at maximum 450mm centres.
- When removing Alumate profiles from the pack do not slide boards against each other, lift the boards and set them down carefully. When handling take care to avoid scratches, nicks and other damage to the boards.
- To ensure long-term performance we recommend that a professional tradesperson carry out the installation in accordance with these instructions, including the use of all trims and accessories.

FRAMING NOTES

Support Sub framing is to be set at a maximum of 450mm centers and must be in line with AS Timber framing must comply with AS 1684: Timber Framing Code. Steel framing must comply with AS/NZS 4600: Cold-Formed Steel Structure or AS 3623: Domestic Metal Framing.

- BCA Volume 2
- 3.4.2 Steel Framing
- 3.5.2 Wall Cladding
- 3.4.3 Timber Framing



PROFILES, STARTERS & TRIMS

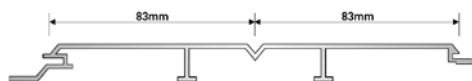

ALC16515V - 83MM VISUAL BOARD COVERAGE



ALC16515 - 165MM VISUAL BOARD COVERAGE

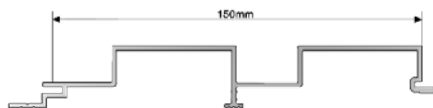

ALC15025 - 150MM VISUAL BOARD COVERAGE

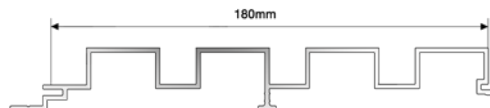

ALC18025 - 180MM VISUAL BOARD COVERAGE



AAC-VERTICAL STARTER



AAC-HORIZONTAL STARTER

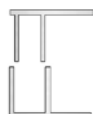

AAC-JTRIM-1&2



AAC-TBAR-1&2

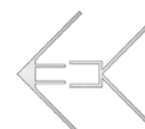

AAC-CORNER-1&2

INSTALLATION NOTES

Use appropriate screws as per the table below and ensure that the head does not exceed the fixing area.

BACK STRUCTURE	SCREW TYPE
SEASONED TIMBER	10G x25MM TYPE 17 WAFER HEAD
STEEL FRAMING	10G X 16MM SELF-DRILLING WAFER HEAD

Aluminium expands and contracts with temperature changes, therefore it is essential that fixings are in the centre of the pre-slotted slots.

When cutting board, starters or trims, always allow for a 5mm clearance under the adjacent trim for expansion and contraction.

When installing onto steel support subframes, ensure to use non-compressible separation tape between the dissimilar metals.

Use appropriate cutting saws suitable for aluminium and ensure they are sharp to reduce the chance of burrs.

To avoid damaging the finish, always use a piece of timber with a rubber mallet to carefully guide the profiles together, if required.

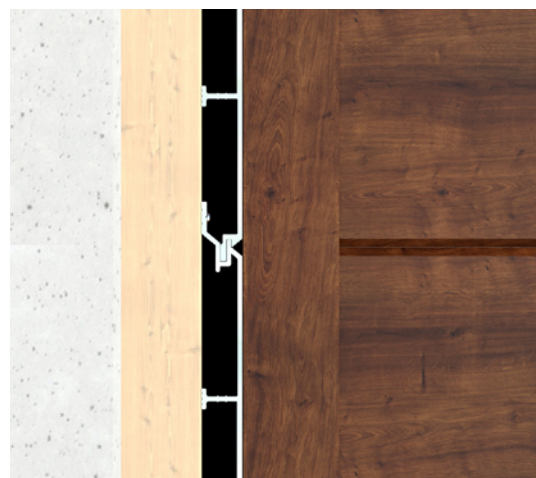

INSTALLATION NOTES

Ensure you are using the correct starter by choosing either the horizontal or the vertical starter dependent on the board orientation.

Level and screw off the starter using the pre-slots at a maximum of 450mm centres in the centre of the slot.

Position the first board into the Starter and ensure that the board is completely seated prior to fixing it off, again using the pre-slots at a maximum of 450mm centres in the centre of the slot.

Continue the installation whilst ensuring that each board is completely seated into each other prior to fixing them using the pre-slots at a maximum of 450mm centres in the centre of the slot.

- FIG 1 - VERTICAL STARTER
- FIG 2 - HORIZONTAL STARTER
- FIG 3 - J TRIM DETAIL
- FIG 4 - CORNER DETAIL
- FIG 5 - T BAR DETAIL

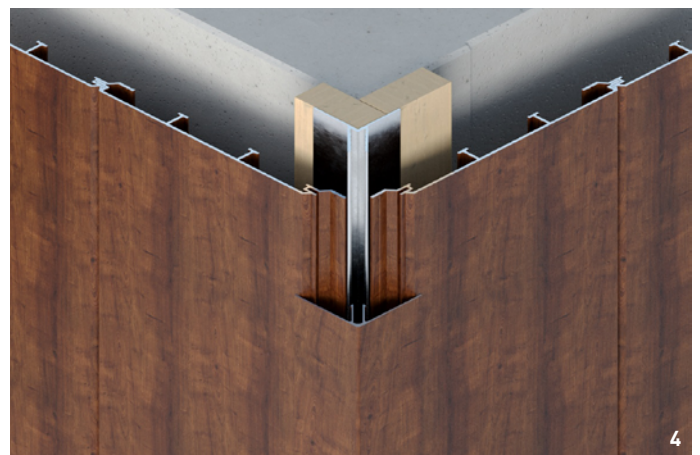
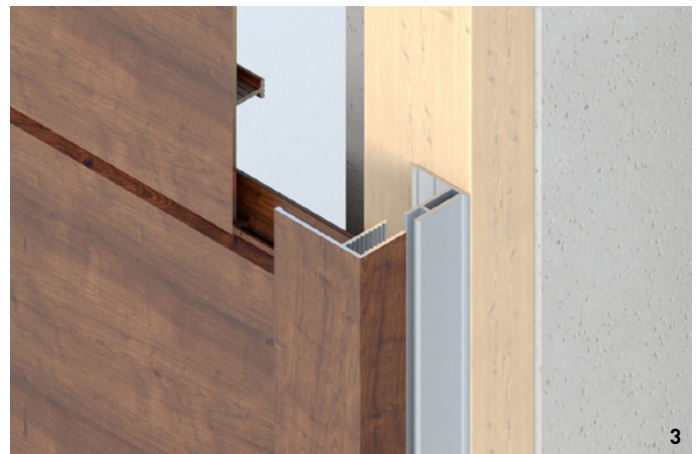
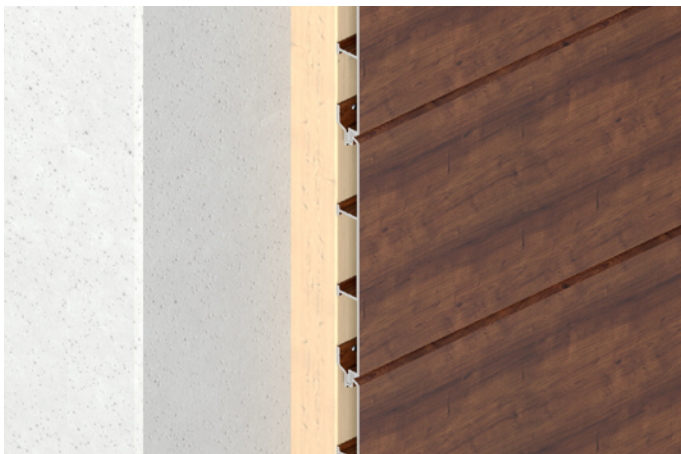



Phone (australia) : +61 (2) 9630 8366 Email : enquiry@alumate.com.au
Office : Unit 15 Jones Bay Wharf, 26-32 Pirrama Road, Pyrmont NSW 2009
Website : www.alumate.com.au